

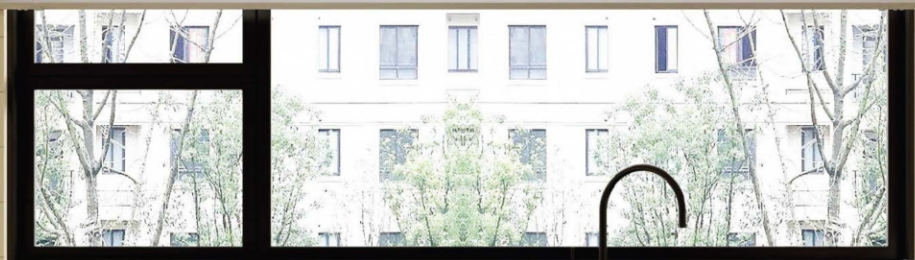

PRODUCT CATALOG



DIAMOND  
BUILT  
INTERIORS





## TABLE OF CONTENTS

About Us.....	4-5
Cabinet Styles.....	6-9
Shaker Cabinets .....	6-7
Vidar Cabinets .....	8-9
Cabinet Construction .....	10-11
Product Specifications .....	12-29
Wall Cabinets .....	12-17
Base Cabinets .....	18-21
Vanity Cabinets.....	22-23
Tall Cabinets .....	24
Fillers and Panels.....	25
Molding and Trim .....	26-27
Accessories .....	28-29
Additional Services .....	30
Forms and Policies .....	31-35
Warranty Policy .....	34
Return Policy .....	35



# ABOUT US

---

Welcome to Diamond Edge Interiors Cabinetry, your preferred source for premium kitchen cabinets in the vibrant Texas area. We take immense pride in offering a stunning range of cabinets that combine superior quality with competitive pricing. At Diamond Edge Interiors Cabinetry, we believe that your dream kitchen should be both beautiful and affordable.

## Our Competitive Edge

Diamond Edge Interiors Cabinetry stands out in the market thanks to our unique advantage. We directly distribute our own cabinets, sourced from overseas manufacturers, which allows us to offer competitive prices without compromising on quality. This direct approach enables us to bring you the best of both worlds - high-quality products at budget-friendly prices.

## A Palette of Choices

Discover a world of possibilities with Diamond Edge Interiors Cabinetry. We offer an extensive selection of cabinets, including the eight most popular colors and styles, as well as the latest slim-edge shaker design that's currently trending. Whether you envision a classic, timeless kitchen or a modern, sleek aesthetic, our catalog has the perfect cabinet to bring your vision to life.

## **Crafted with Premium Materials**

Quality is at the core of everything we do, starting with the materials we use. At Diamond Edge Interiors Cabinetry, we exclusively utilize premium woods such as birch, American white oak, and Canadian maple to construct our cabinets. This commitment to using the finest materials ensures that our cabinets are not only visually appealing but also built to withstand the test of time.

## **No Order Too Small or Too Large**

At Diamond Edge Interiors Cabinetry, we are dedicated to serving dealers and trade professionals exclusively. We welcome orders of any size, from individual kitchen remodels to container loads of cabinets. Our flexibility is designed to accommodate your unique requirements, ensuring a seamless and hassle-free experience for our valued dealer partners.

## **For Trade Professionals and Beyond**

Diamond Edge Interiors Cabinetry extends a warm welcome to trade customers, including contractors, home improvement stores, builders, and developers. We understand your unique requirements and are here to support your projects with top-tier products and exceptional service. Partner with us and experience the difference in quality and affordability.

## **Try Diamond Edge Interiors Cabinetry Today**

We invite dealers and trade professionals to experience the Diamond Edge Interiors Cabinetry difference. Give us a try, and you'll discover that quality, affordability, and exceptional service are the cornerstones of our business. Join our satisfied partners and elevate your projects with our exquisite cabinets.

Thank you for considering Diamond Edge Interiors Cabinetry as your trusted source for premium kitchen cabinets.



# SHAKER CABINETS

## Elevate Your Kitchen with Timeless Elegance

Our shaker style cabinets are a testament to the enduring appeal of classic design. Crafted with precision and care, these cabinets come in five distinct colors and styles:

**Shaker Arctic (White Shaker):** Clean, crisp, and versatile, Shaker Arctic cabinets bring a bright and inviting atmosphere to your kitchen.

**Shaker Stone (Light Gray Shaker):** Strike the perfect balance between sophistication and warmth with Shaker Stone cabinets, ideal for creating a modern and cozy kitchen.

**Shaker Midnight (Blue Shaker):** Make a bold statement with Shaker Midnight cabinets, injecting personality and vibrancy into your space.

**Shaker Jade (Green Shaker):** For a fresh and contemporary vibe, Shaker Jade cabinets are the perfect choice.

**Shaker Maple (Natural Canadian Maple Wood Shaker):** Experience the beauty of natural wood with Shaker Maple cabinets, adding rustic charm to your kitchen.

In all our shaker Style cabinets, we use premium wood selections, upgrade hardware, and a premium American-based grade of paint. Our meticulous attention to quality during material selection ensures that your cabinets stand the test of time, with colors that won't fade away. Each cabinet is constructed using the most durable dovetail construction to withstand frequent use without falling apart. The upgraded hardware enhances functionality and durability, while multiple layers of paint ensure a smooth surface finish and long-lasting color protection. The feel and touch of these cabinets exemplify our commitment to excellence.





SHAKER ARCTIC (SA)



SHAKER STONE (SS)

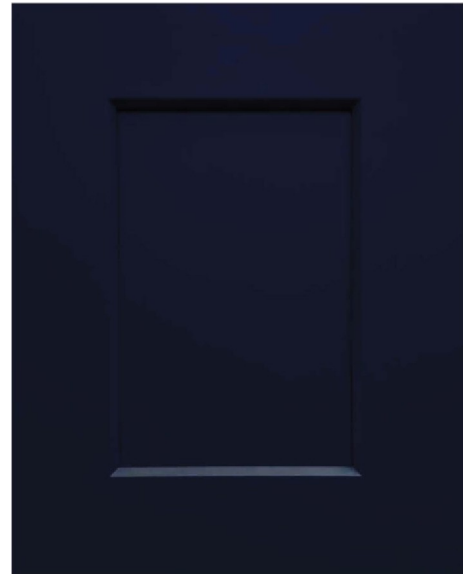

SHAKER MIDNIGHT (SN)



SHAKER JADE (SJ)



SHAKER MAPLE (SM)

# VIDAR CABINETS

## Embrace Modern Elegance with Slim Shaker Cabinets

Discover the latest trend in cabinet design with Diamond Edge Interiors Cabinetry's Slim Shaker Cabinets, the Vidar Collection. This collection offers a sleek and contemporary aesthetic, perfect for those looking to infuse a modern vibe into their kitchen. Our Vidar Cabinets are designed to redefine your kitchen's style and functionality, available in three distinctive options:

**Vidar Pearl (White Slim Shaker):** The soft and neutral Vidar Pearl cabinets exude sophistication and versatility, allowing you to create a calming and elegant kitchen space.

**Vidar Onyx (Black Slim Shaker):** Make a bold statement with Vidar Onyx cabinets, adding a touch of drama and modern elegance to your kitchen.

**Vidar Oak (Natural American White Oak Slim Shaker):** Experience the timeless beauty of American white oak in a modern slim edge shaker style with Vidar Oak cabinets, blending classic charm with contemporary design.

In our Vidar Cabinets, we maintain our commitment to premium wood selection, upgraded hardware, and a superior American-based paint grade. Quality and durability are at the forefront of our design, ensuring that your cabinets are not only visually striking but also built to last. Embrace modern elegance and redefine your kitchen's aesthetics with Diamond Edge Interiors Cabinetry's Slim Edge Shaker Cabinets.





VIDAR PEARL (VP)

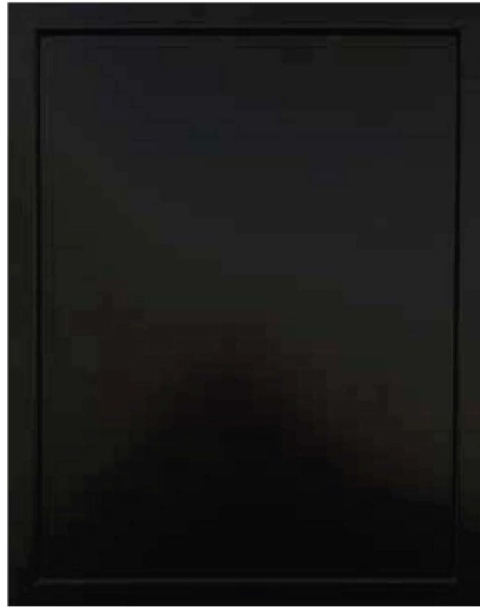

VIDAR ONYX (VX)



VIDAR OAK (VO)

# Cabinet Construction

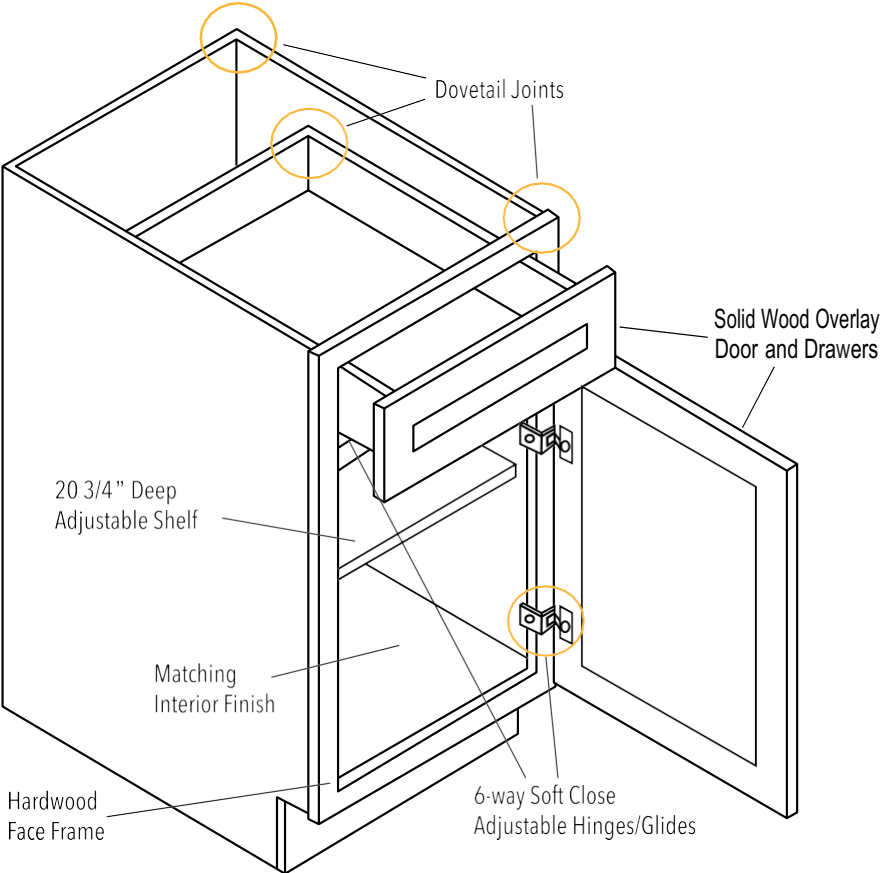

	<b>SHAKER ARCTIC (SA)</b>
<b>Cabinet Box</b>	1/2", 7 Ply, Plywood, Dovetail Joints
<b>Drawer Box</b>	5/8" Solid Wood, Dovetail Joints
<b>Drawer Slides</b>	Under Mount, Full Extension, Metal, Soft Close w/ Ball Bearings, DTC Hardware
<b>Wood Species</b>	Birch
<b>Door Hinge</b>	DTC 6-Way Adjustable, Soft Close
<b>Shelves</b>	Adjustable, 3/4" Plywood
<b>Finish Color</b>	Arctic White
<b>Exterior Finish</b>	Matching Door
<b>Interior Finish</b>	Matching Interior
<b>Base Reinforcement</b>	3" Plywood Stretchers
<b>Face Frame</b>	1 1/2" Rails and Stiles, Solid Wood
<b>Full Overlay Door/Drawer</b>	5-Piece w/ Solid Center Panel, 3 1/2" Stiles and Rails
<b>Design &amp; Structure</b>	Meets Leading Industry Standards
<b>Assembly</b>	Staples, Nails, and Brackets

<b>SHAKER STONE (SS)</b>	<b>SHAKER MIDNIGHT (SN)</b>	<b>SHAKER JADE (SJ)</b>	<b>SHAKER MAPLE (SM)</b>	<b>VIDAR PEARL (VP)</b>	<b>VIDAR ONYX (VX)</b>	<b>VIDAR OAK (VO)</b>
1/2", 7 Ply, Plywood, Dovetail Joints	1/2", 7 Ply, Plywood, Dovetail Joints	1/2", 7 Ply, Plywood, Dovetail Joints	1/2", 7 Ply, Plywood, Dovetail Joints	1/2", 7 Ply, Plywood, Dovetail Joints	1/2", 7 Ply, Plywood, Dovetail Joints	1/2", 7 Ply, Plywood, Dovetail Joints
5/8" Solid Wood, Dovetail Joints	5/8" Solid Wood, Dovetail Joints	5/8" Solid Wood, Dovetail Joints	5/8" Solid Wood, Dovetail Joints	5/8" Solid Wood, Dovetail Joints	5/8" Solid Wood, Dovetail Joints	5/8" Solid Wood, Dovetail Joints
Under Mount, Full Extension, Metal, Soft Close w/ Ball Bearings, DTC Hardware	Under Mount, Full Extension, Metal, Soft Close w/ Ball Bearings, DTC Hardware	Under Mount, Full Extension, Metal, Soft Close w/ Ball Bearings, DTC Hardware	Under Mount, Full Extension, Metal, Soft Close w/ Ball Bearings, DTC Hardware	Under Mount, Full Extension, Metal, Soft Close w/ Ball Bearings, DTC Hardware	Under Mount, Full Extension, Metal, Soft Close w/ Ball Bearings, DTC Hardware	Under Mount, Full Extension, Metal, Soft Close w/ Ball Bearings, DTC Hardware
Birch	Birch	Birch	Canadian Maple	Birch	Birch	American White Oak
DTC 6-Way Adjustable, Soft Close	DTC 6-Way Adjustable, Soft Close	DTC 6-Way Adjustable, Soft Close	DTC 6-Way Adjustable, Soft Close	DTC 6-Way Adjustable, Soft Close	DTC 6-Way Adjustable, Soft Close	DTC 6-Way Adjustable, Soft Close
Adjustable, 3/4" Plywood	Adjustable, 3/4" Plywood	Adjustable, 3/4" Plywood	Adjustable, 3/4" Plywood	Adjustable, 3/4" Plywood	Adjustable, 3/4" Plywood	Adjustable, 3/4" Plywood
Stone Gray	Midnight Blue	Jade Green	Maple (Natural)	Pearl White	Onyx Black	Oak (Natural)
Matching Door	Matching Door	Matching Door	Matching Door	Matching Door	Matching Door	Matching Door
Matching Interior	Matching Interior	Natural	Matching Interior	Matching Interior	Matching Interior	Matching Interior
3" Plywood Stretchers	3" Plywood Stretchers	3" Plywood Stretchers	3" Plywood Stretchers	3" Plywood Stretchers	3" Plywood Stretchers	3" Plywood Stretchers
1 1/2" Rails and Stiles, Solid Wood	1 1/2" Rails and Stiles, Solid Wood	1 1/2" Rails and Stiles, Solid Wood	1 1/2" Rails and Stiles, Solid Wood	1 1/2" Rails and Stiles, Solid Wood	1 1/2" Rails and Stiles, Solid Wood	1 1/2" Rails and Stiles, Solid Wood
5-Piece w/ Solid Center Panel, 3 1/2" Stiles and Rails	5-Piece w/ Solid Center Panel, 3 1/2" Stiles and Rails	5-Piece w/ Solid Center Panel, 3 1/2" Stiles and Rails	5-Piece w/ Solid Center Panel, 3 1/2" Stiles and Rails	5-Piece w/ Solid Center Panel, 3 1/2" Stiles and Rails	5-Piece w/ Solid Center Panel, 3 1/2" Stiles and Rails	5-Piece w/ Solid Center Panel, 3 1/2" Stiles and Rails
Meets Leading Industry Standards	Meets Leading Industry Standards	Meets Leading Industry Standards	Meets Leading Industry Standards	Meets Leading Industry Standards	Meets Leading Industry Standards	Meets Leading Industry Standards
Staples, Nails, and Brackets	Staples, Nails, and Brackets	Staples, Nails, and Brackets	Staples, Nails, and Brackets	Staples, Nails, and Brackets	Staples, Nails, and Brackets	Staples, Nails, and Brackets

**30" WALL CABINET  
SINGLE DOOR**

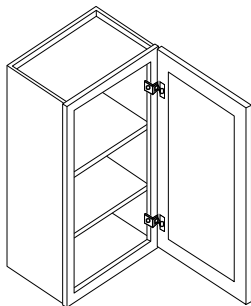

	W	H	D
W0930	9"	30"	12"
W1230	12"	30"	12"
W1530	15"	30"	12"
W1830	18"	30"	12"
W2130	21"	30"	12"

\*comes with 2 shelves

**36" WALL CABINET  
SINGLE DOOR**

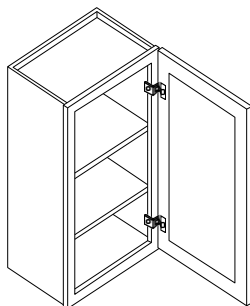

	W	H	D
W0936	9"	36"	12"
W1236	12"	36"	12"
W1536	15"	36"	12"
W1836	18"	36"	12"
W2136	21"	36"	12"

\*comes with 2 shelves

**42" WALL CABINET  
SINGLE DOOR**

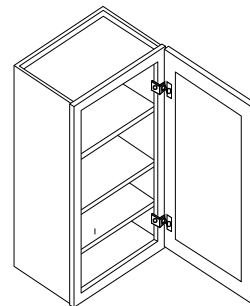

	W	H	D
W0942	9"	42"	12"
W1242	12"	42"	12"
W1542	15"	42"	12"
W1842	18"	42"	12"
W2142	21"	42"	12"

\*comes with 3 shelves

**30" WALL CABINET  
DOUBLE DOOR**

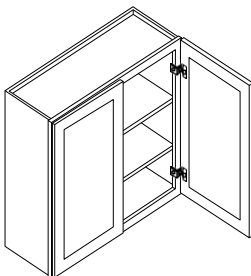

	W	H	D
W2430	24"	30"	12"
W2730	27"	30"	12"
W3030	30"	30"	12"
W3330	33"	30"	12"
W3630	36"	30"	12"
W4230	42"	30"	12"

\*comes with 2 shelves  
\*39"/42" have center stile

**36" WALL CABINET  
DOUBLE DOOR**

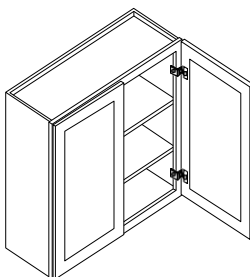

	W	H	D
W2436	24"	36"	12"
W2736	27"	36"	12"
W3036	30"	36"	12"
W3336	33"	36"	12"
W3636	36"	36"	12"
W4236	42"	36"	12"

\*comes with 2 shelves  
\*39"/42" have center stile

**42" WALL CABINET  
DOUBLE DOOR**

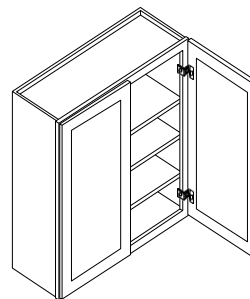

	W	H	D
W2442	24"	42"	12"
W2742	27"	42"	12"
W3042	30"	42"	12"
W3342	33"	42"	12"
W3642	36"	42"	12"
W4242	42"	42"	12"

\*comes with 3 shelves  
\*39"/42" have center stile

**12" WALL CABINET SINGLE DOOR**

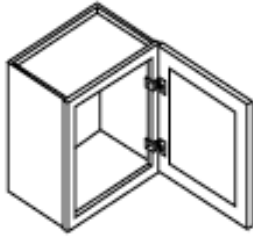

	W	H	D
W1212	12"	12"	12"
W1512	15"	12"	12"
W1812	18"	12"	12"
W2112	21"	12"	12"

**12"/15"/18"/21" WALL CABINET DOUBLE DOOR**

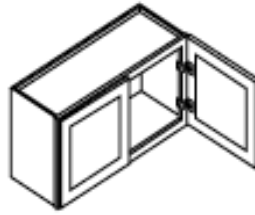

	W	H	D
W2412	24"	12"	12"
W2712	27"	12"	12"
W3012	30"	12"	12"
W3312	33"	12"	12"
W3612	36"	12"	12"
W3015	30"	15"	12"
W3315	33"	15"	12"
W3615	36"	15"	12"
W1818	18"	18"	12"
W2418	24"	18"	12"
W3018	30"	18"	12"
W3318	33"	18"	12"
W3618	36"	18"	12"
W3021	30"	21"	12"
W3621	36"	21"	12"

**12"/15"/18"/21" REFRIGERATOR WALL CABINET**

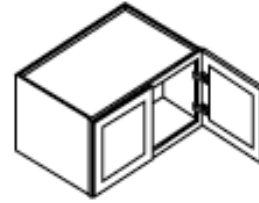

	W	H	D
W301224	30"	12"	24"
W301524	30"	15"	24"
W301824	30"	18"	24"
W302124	30"	21"	24"
W331224	33"	12"	24"
W331524	33"	15"	24"
W331824	33"	18"	24"
W332124	33"	21"	24"
W361224	36"	12"	24"
W361524	36"	15"	24"
W361824	36"	18"	24"
W362124	36"	21"	24"

**24" WALL CABINET DOUBLE DOOR**

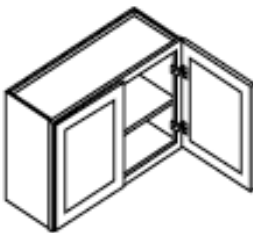

	W	H	D
W2442	24"	42"	12"
W2742	27"	42"	12"
W3042	30"	42"	12"
W3342	33"	42"	12"
W3642	36"	42"	12"

\*comes with 1 shelf

**24" REFRIGERATOR WALL CABINET**

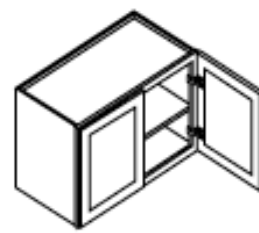

	W	H	D
W302424	30"	24"	24"
W332424	33"	24"	24"
W362424	36"	24"	24"

\*comes with 1 shelf

**30" /36" WALL BLIND CORNER CABINET**

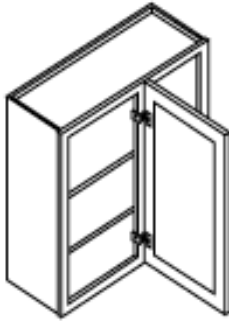

	W	H	D
WBC2730	27"	30"	12"
WBC2736	27"	36"	12"
WBC3030	30"	30"	12"
WBC3036	30"	36"	12"

\*comes with 2 shelves  
 \*image shown is left hinged

**30" /36" EASY REACH CORNER WALL CABINET**

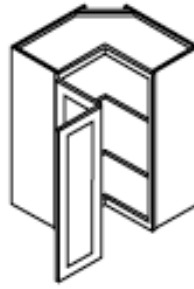

	W	H	D
WERC2430	24"	30"	12"
WERC2436	24"	36"	12"

\*comes with 2 shelves

**30" /36" WALL DIAGONAL CORNER CABINET**



	W	H	D
WDC2430	24"	30"	12"
WDC2436	24"	36"	12"
WDC2736	27"	36"	12"

\*comes with 2 shelves

**42" WALL BLIND CORNER CABINET**

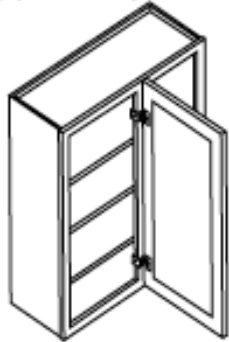

	W	H	D
WBC 2442	24"	42"	12"
WBC 2742	27"	42"	12"
WBC 3042	30"	42"	12"
WBC 3642	36"	42"	12"

\*comes with 3 shelves  
 \*image shown is left hinged

**42" EASY REACH CORNER WALL CABINET**

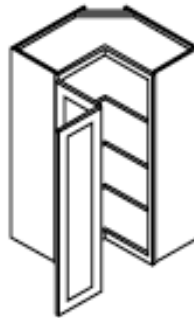

	W	H	D
WERC2442	24	42	12

\*comes with 3 shelves

**42" WALL DIAGONAL CORNER CABINET**



	W	H	D
WDC2442	24"	42"	12"
WDC2742	27"	42"	12"

\*comes with 3 shelves

**18" WALL DIAGONAL CORNER CABINET**



	W	H	D
WBC2418	24"	18"	12"

**30"/36" WALL END CABINET**

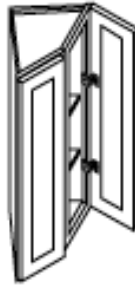

	W	H	D
WEC1230	12"	30"	12"
WEC1236	12"	36"	12"

\*comes with 2 shelves

**30"/36" WALL OPEN END SHELF CABINET**



	W	H	D
WOES0630	6"	30"	12"
WOES0636	6"	36"	12"
WOES0930	9"	30"	12"
WOES0936	9"	36"	12"
WOES1230	12"	30"	12"
WOES1236	12"	36"	12"

\*comes with 2 shelves

**WALL MICROWAVE CABINET**

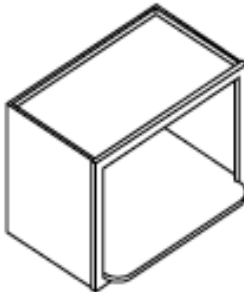

	W	H	D
WM3018	30"	18"	12"

\*shelf is 15" deep  
\*opening is 27"x14-1/4"

**42 WALL END CABINET**

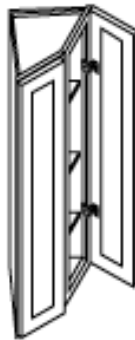

	W	H	D
WEC1242	12"	42"	12"

\*comes with 3 shelves

**42 WALL OPEN END SHELF CABINET**



	W	H	D
WOES0642	6"	42"	12"
WOES0942	9"	42"	12"
WOES1242	12"	42"	12"

\*comes with 3 shelves

**15" /18" CRISS -CROSSED  
WINE RACK CABINET**

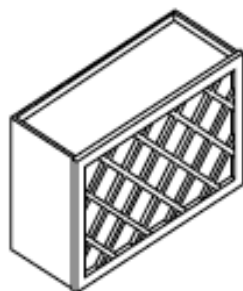

	W	H	D
WR3018	30"	18"	12"
WR3618	36"	18"	12"

**6" WINE CUBE CABINET**

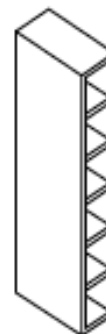

	W	H	D
WWC0630	6"	30"	12"

**GLASS DOOR ADD-ONS FOR WALL CABINETS**

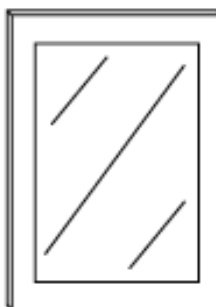

W1530GD	W1536GD	W1542GD	W2112GD	WDC2430GD
W1830GD	W1836GD	W1842GD	W2412GD	WDC2436GD
W2430GD	W2436GD	W2442GD	W3612GD	WDC2442GD
W3030GD	W3036GD	W3042GD		

**ONLY AVAILABLE IN SHAKER SERIES**

## BASE CABINET FULL HEIGHT SINGLE DOOR

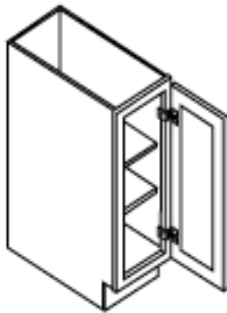

	W	H	D
B06FHD	6"	34.5"	24"
B09FHD	9"	34.5"	24"
B12FHD	12"	34.5"	24"
B15FHD	15"	34.5"	24"
B21FHD	21"	34.5"	24"

\*comes with 2 shelves

## BASE CABINET FULL HEIGHT DOUBLE DOOR

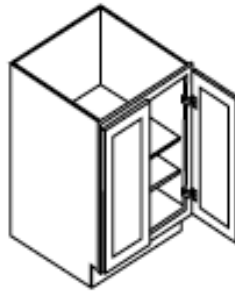

	W	H	D
B24FHD	24"	34.5"	24"
B27FHD	27"	34.5"	24"
B30FHD	30"	34.5"	24"
B33FHD	33"	34.5"	24"
B36FHD	36"	34.5"	24"

\*comes with 2 shelves

## BASE CABINET TWO DOORS/ONE DRAWER

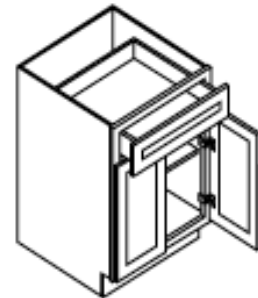

	W	H	D
B24	24"	34.5"	24"
B27	27"	34.5"	24"
B30	30"	34.5"	24"

## BASE CABINET ONE DOOR/ONE DRAWER

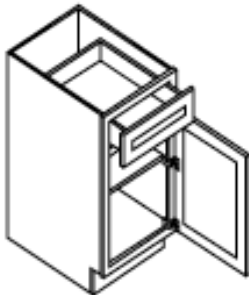

	W	H	D
B09	9"	34.5"	24"
B12	12"	34.5"	24"
B15	15"	34.5"	24"
B18	18"	34.5"	24"
B21	21"	34.5"	24"

## BASE CABINET TWO DOOR/TWO DRAWERS

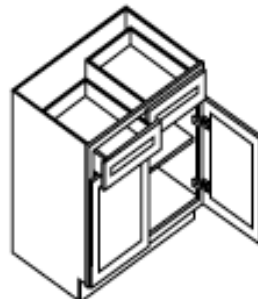

	W	H	D
B33	33"	34.5"	24"
B36	36"	34.5"	24"
B39	39"	34.5"	24"
B42	42"	34.5"	24"

\*39"/42" have center stile

## BASE SPICE RACK CABINET

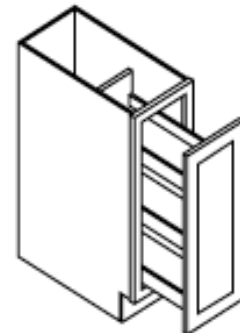

	W	H	D
B06SR	6"	34.5"	24"
B09SR	9"	34.5"	24"
B12SR	12"	34.5"	24"

### EASY REACH BASE CABINET

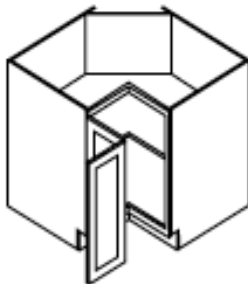

	W	H	D
ERB33	33"	34.5"	24"
ERB36	36"	34.5"	24"

\*lazy susan tray are available for add-on

### BASE BLIND CORNER CABINET

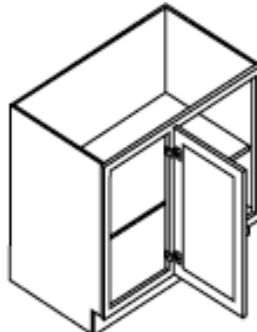

	W	H	D
BBC36	36"	34.5"	24"
BBC39	39"	34.5"	24"
BBC42	42"	34.5"	24"

\*min. pull out 3"  
\*BBC39/BBC42 max pull out 9"

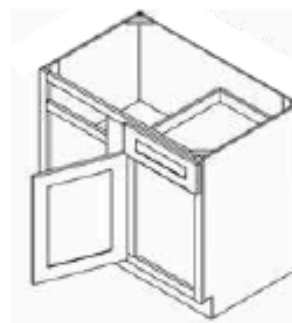

	W	H	D
BBC45	45"	34.5"	24"

\*min. pull out 3"  
\*BBC45 max pull out 6"  
\*BBC45 has a drawer

### TWO DRAWERS BASE CABINET

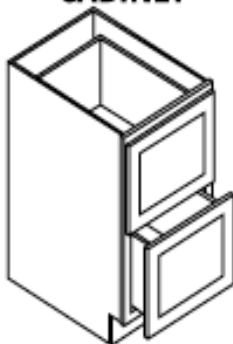

	W	H	D
DB24-2	24"	34.5"	24"
DB30-2	30"	34.5"	24"
DB36-2	36"	34.5"	24"

\*drawer height: 14-1/4"

### THREE DRAWERS BASE CABINET

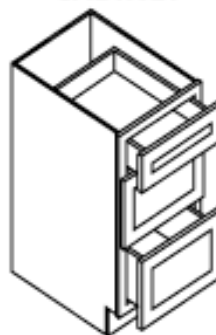

	W	H	D
DB12-3	12"	34.5"	24"
DB15-3	15"	34.5"	24"
DB18-3	18"	34.5"	24"
DB21-3	21"	34.5"	24"
DB24-3	24"	34.5"	24"
DB27-3	27"	34.5"	24"
DB30-3	30"	34.5"	24"
DB33-3	33"	34.5"	24"
DB36-3	36"	34.5"	24"

\*drawer height (bottom 2): 11-1/8"

**SINK BASE CABINET**

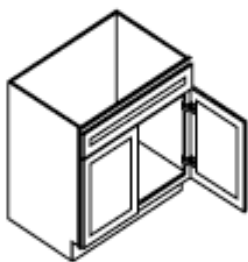

	W	H	D
SB24	24"	34.5"	24"
SB27	27"	34.5"	24"
SB30	30"	34.5"	24"
SB33	33"	34.5"	24"
SB36	36"	34.5"	24"
SB42	42"	34.5"	24"

\*false drawer front

**FARM SINK BASE CABINET**

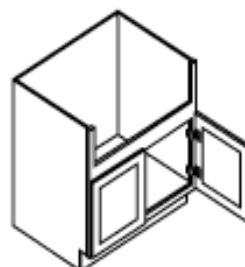

	W	H	D
FSB36	36"	34.5"	24"
FSB39	39"	34.5"	24"

\*FSB30 fits max 27" sink  
\*FSB36 fits max 33" sink

**SINK BASE ANGLE CABINET**

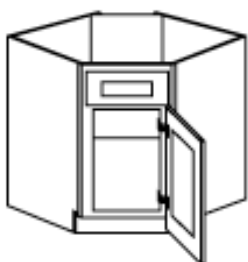

	W	H	D
SBA36	36"	34.5"	24"

\*false drawer front

**BASE DOUBLE WASTE BASKET CABINET**

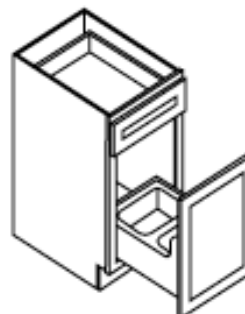

	W	H	D
BWB18	18"	34.5"	24"

\*trash bin sold separately

**BASE MICROWAVE  
CABINET**

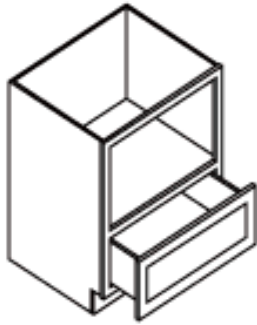

	W	H	D
BMC30	30"	34.5"	24"
BMC33	33"	34.5"	24"

\*opening is 27"x16-1/8"

**BASE OPEN  
END SHELF CABINET**

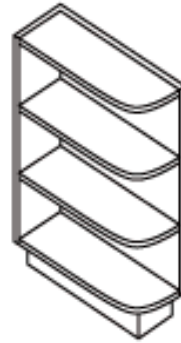

	W	H	D
BOES12	12"	34.5"	24"

**BASE END CABINET**

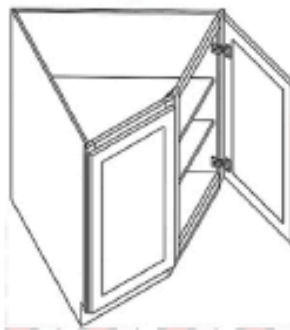

	W	H	D
BEC24	24"	34.5"	24"

**VANITY BASE CABINET ONE DOOR/ONE DRAWER**

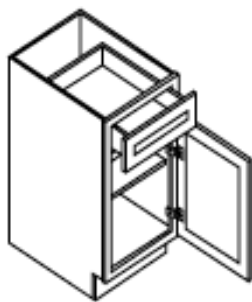

	W	H	D
VB15	15"	34.5"	21"

**VANITY DRAWER BASE CABINET**

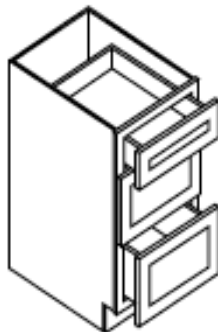

	W	H	D
VDB12	12"	34.5"	21"
VDB15	15"	34.5"	21"
VDB18	18"	34.5"	21"
VDB21	21"	34.5"	21"

\*drawer height (bottom 2): 11-1/8"

**VANITY SINK BASE CABINET**

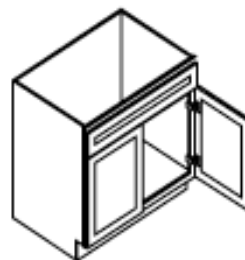

	W	H	D
VSB24	24"	34.5"	21"
VSB27	27"	34.5"	21"
VSB30	30"	34.5"	21"
VSB33	33"	34.5"	21"
VSV36	36"	34.5"	21"

\*false drawer front

**VANITY LINEN CABINET**

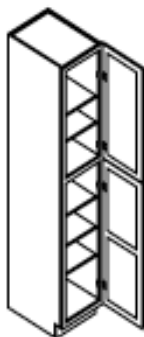

	W	H	D
VP1884	18"	84"	21"

**Knee Drawer**

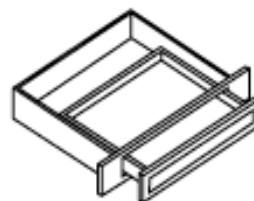

	W	H	D
KN30	30"	4.5"	21"
KN36	36"	4.5"	21"

### 30" VANITY BASE CABINET COMBO

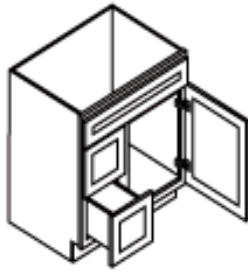

	W	H	D
VSD30L	30"	34.5"	21"

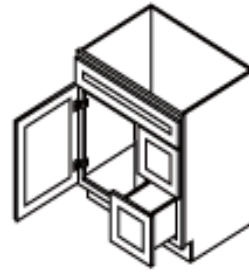

	W	H	D
VSD30R	30"	34.5"	21"

\*false drawer front  
\*L/R is the side of the drawers

### 36" VANITY BASE CABINET COMBO

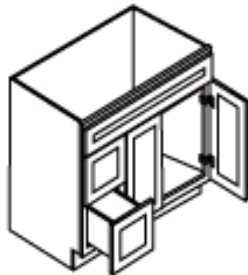

	W	H	D
VSD36L	36"	34.5"	21"

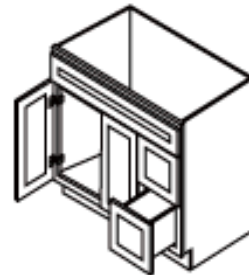

	W	H	D
VSD36R	36"	34.5"	21"

\*false drawer front  
\*L/R is the side of the drawers

### 42" VANITY BASE CABINET COMBO

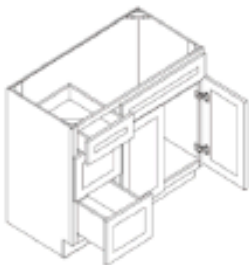

	W	H	D
VSD42L	42"	34.5"	21"

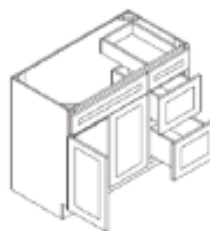

VSD42R	42"	34.5"	21"
--------	-----	-------	-----

### 48" VANITY BASE CABINET COMBO

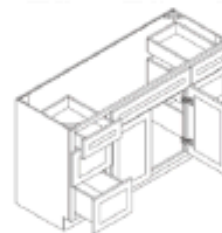

	W	H	D
VSD48	48"	34.5"	21"

**18" PANTRY CABINET  
SINGLE DOOR**

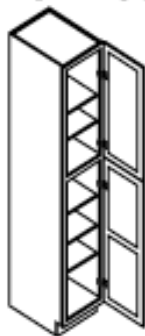

	W	H	D
P1884	18"	84"	24"
P1890	18"	90"	24"
P1896	18"	96"	24"

**24"/30" PANTRY CABINET  
DOUBLE DOOR**

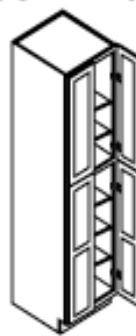

	W	H	D
P2484	24"	84"	24"
P2490	24"	90"	24"
P2496	24"	96"	24"
P3084	30"	84"	24"
P3090	30"	90"	24"
P3096	30"	96"	24"

**DOUBLE OVEN CABINET**

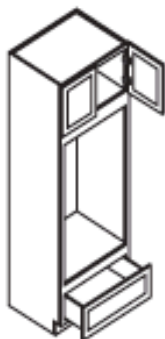

	W	H	D
OC3384D	33"	84"	24"
OC3390D	33"	90"	24"
OC3396D	33"	96"	24"

\*opening is 28-1/2"x49-3/4"

**SINGLE OVEN CABINET**

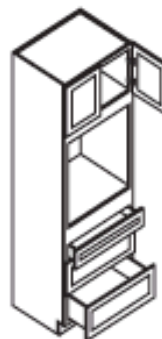

	W	H	D
OC3384S	33"	84"	24"
OC3390S	33"	90"	24"
OC3396S	33"	96"	24"

\*opening is 28-1/2"x30"

**BASE FILLER**



	W	H
BF3	3"	34.5"
BF6	6"	34.5"

**DISH WASHER PANEL  
W/ 3" RETURN**

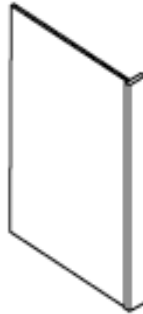

	W	H	D
DWP3	3"	34.5"	24"

**REFRIGERATOR PANEL**



	W	H	D
REP3096	30"	96"	3/4"

**WALL/TALL FILLER**



	W	H
WF330	3"	30"
WF336	3"	36"
WF342	3"	42"
WF630	6"	30"
WF636	6"	36"
WF642	6"	42"
TF1.596	1.5"	96"
TF396	3"	96"
TF696	6"	96"

**REFRIGERATOR PANEL  
W/ 1 1/2" RETURN**



	W	H	D
REP2496	1.5"	96"	24"
REP3096	1.5"	96"	24"

**BASE PANEL**



	W	H	D
PN4896	48"	96"	1/4"
BSV23	1/4"	34.5"	1/4"
WSV	15"	42"	1/4"

**TOE KICK (TK8)**

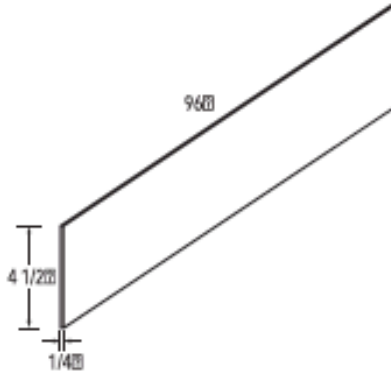

**COVE MOLDING (COV8)**

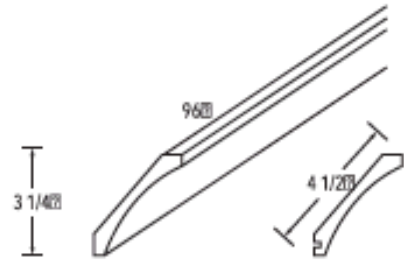

**CROWN MOLDING 2 1/2" (CM2)**

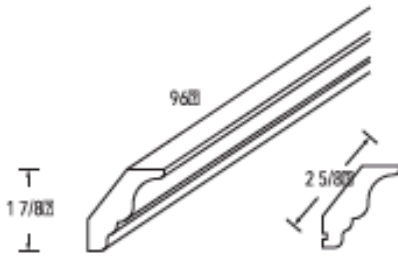

**BASE BOARD (BBM8)**

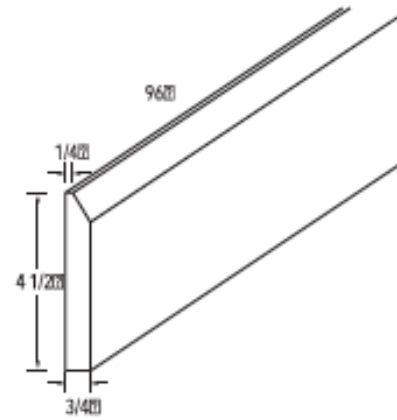

**CROWN MOLDING 4 1/2" (CM4)**

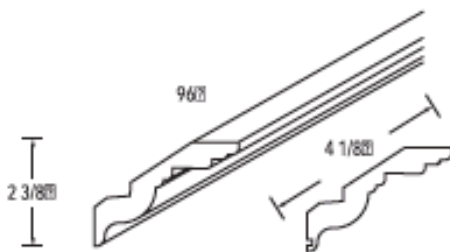

**LIGHT RAIL MOLDING (LRM8)**

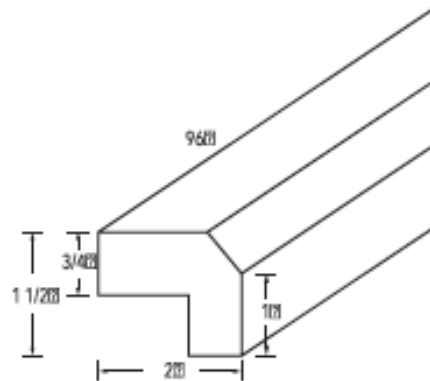

**SCRIBE MOLDING (SM8)**

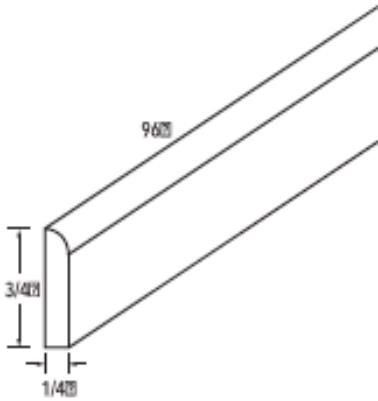

**OUTSIDE CORNER MOLDING (OCM8)**

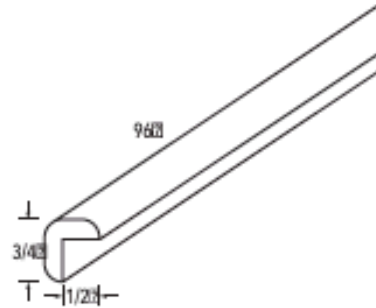

**QUARTER ROUND MOLDING (QRM8)**

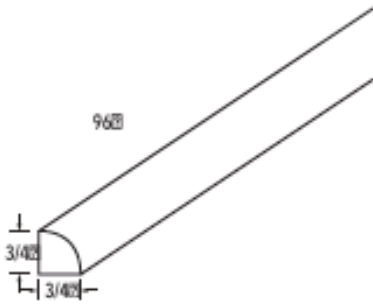

**INSIDE CORNER MOLDING (ICM8)**

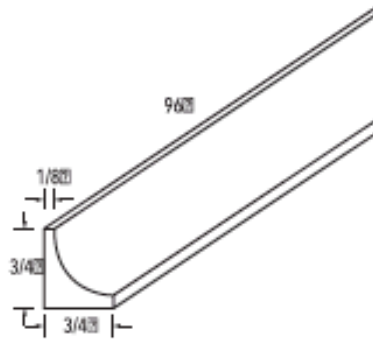

**SCRIBE BEVELED MOLDING (SBM8)**

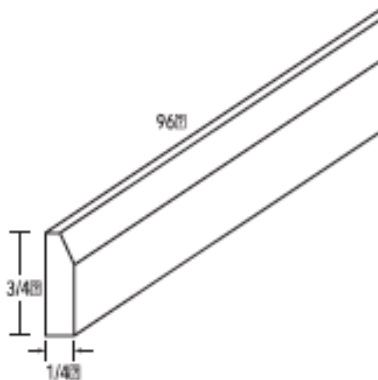

### DUMMY DOORS

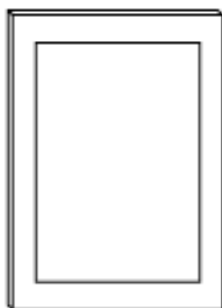

	W	H	D
BRP2430	24 "	30 "	3/4"
WRP1230	12 "	30 "	3/4"
WRP1236	12 "	36 "	3/4"
WRP1242	12 "	42 "	3/4"
UPRP2436	24 "	36 "	3/4"
UPRP2442	24 "	42 "	3/4"

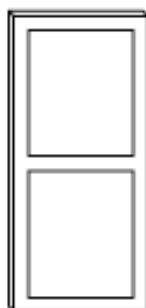

	W	H	D
BPRP	24 "	49.5"	3/4"

### ROLL OUT TRAYS

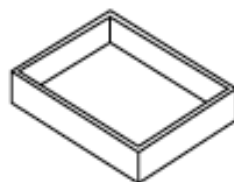

	W	H	D
ROT12	8"	4 1/4"	19 3/8"
ROT15	11"	4 1/4"	19 3/8"
ROT18	14"	4 1/4"	19 3/8"
ROT21	17"	4 1/4"	19 3/8"
ROT24	20"	4 1/4"	19 3/8"
ROT27	23"	4 1/4"	19 3/8"
ROT30	26"	4 1/4"	19 3/8"
ROT33	29"	4 1/4"	19 3/8"
ROT36	32"	4 1/4"	19 3/8"

### STEM GLASS HOLDERS



	W	H	D
SGH30	28.5 "	1.5 "	10.5"
SGH36	34.5 "	1.5"	10.5"

### LAZY SUSAN TRAYS



	W
BLS33-TRAY	25-7/8"
BLS36-TRAY	28-3/4"

### VALANCE

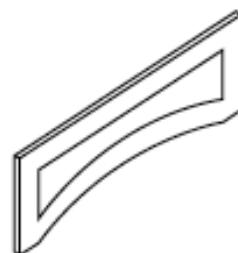

	W	H	D
VAL36	36 "	12 "	3/4"
VAL42	42 "	12 "	3/4"
VAL48	48 "	12 "	3/4"
VAL60	60 "	12 "	3/4"

\*VAL36 is a Flat Panel

**POST**



	W	H	D
POST	3.5"	34.5"	3.5"

**CORBEL**



	W	H	D
CORBEL	6"	12"	5"

**FLOATING SHELVES**

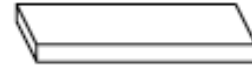

	W	H	D
FLS36	36"	2.5"	10"
FLS48	48"	2.5"	10"

CALL TO CHECK AVAILABILITY

**TRASH BIN**



	NEED
BWB18	2

**TOUCH-UP KIT**

Including: Touch-Up Marker

- Sponge
- Crayon
- Plastic Blade

SHAKER ARCTIC (SA)
SHAKER STONE (SS)
SHAKER MIDNIGHT (SN)
SHAKER JADE (SJ)
SHAKER MAPLE (SM)
VIDAR PEARL (VP)
VIDAR ONYX (VX)
VIDAR OAK (VO)

**SAMPLE DOOR**

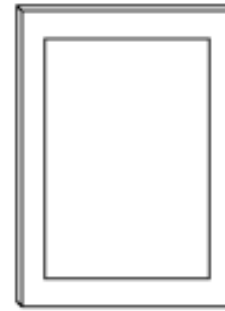

SHAKER ARCTIC (SA)
SHAKER STONE (SS)
SHAKER MIDNIGHT (SN)
SHAKER JADE (SJ)
SHAKER MAPLE (SM)
VIDAR PEARL (VP)
VIDAR ONYX (VX)
VIDAR OAK (VO)

# ADDITIONAL SERVICES

## Assembly Charges

SERVICE	NET COST
Regular Cabinet Assembly Charge	\$20
Complex Cabinet Assembly Charge	\$30
Insert Base Accessories	\$70
Insert Corner Accessories	\$90
Insert Wall Accessories	\$90

MODIFICATION OPTIONS	DESCRIPTION	NET COST
Convert to BASE to SINK BASE	Convert a base cabinet to a sink base cabinet	FREE
Cut BASE with Drawers	Reduce depth of a regular base cabinets (new drawer glides not included)	\$90
Cut BASE/SINK BASE	Reduce depth of base cabinets without drawers	\$70
Cut DRAWER BASE	Reduce depth of drawer cabinets (new drawer glides not included)	\$100
Cut WALL	Reduce depth of a wall cabinet	\$70
CutTALL	Reduce depth of a tall cabinet	\$100
Cut ROT	Reduce depth of a roll-out tray	\$50
Increase Depth of WALL	Increase deapth of a wall cabinet	\$90
Convert to WALL BLIND CORNER	Convert a wall cabinet to a wall blind corner cabinet	\$90
		\$120
f Advanced	Modification on oven cabinet for complex and advanced requirement	\$150
		\$90
Attach TK	Attach toe kick box to a cabinet	\$70



## Account Application Form

Company Name: \_\_\_\_\_

DBA (if different): \_\_\_\_\_

Contact Person: \_\_\_\_\_

Business Address: \_\_\_\_\_

City \_\_\_\_\_ State: \_\_\_\_\_ Zip Code: \_\_\_\_\_

Phone: \_\_\_\_\_ Email: \_\_\_\_\_

Business Type:  Sole Proprietorship  Partnership  Corporation  
 LLC  **INC**  Other, please specify \_\_\_\_\_

Business Established Date: \_\_\_\_\_ Business License Number: \_\_\_\_\_

Federal Tax ID Number (EIN): \_\_\_\_\_

Tax Exempt: \_\_\_\_\_ No. \_\_\_\_\_ Yes Tax Exempt No: \_\_\_\_\_

Have you ever had an account with us before? \_\_\_\_\_ No \_\_\_\_\_ Yes

If Yes, under what name? \_\_\_\_\_

Authorized Signature: \_\_\_\_\_

Print Name: \_\_\_\_\_

Title: \_\_\_\_\_ Date: \_\_\_\_\_

13220 Starkey Road, Suite 800,  
Largo, FL 33773  
(737) 376-2103  
sales@diamondedgeinteriors.com





## Return/Replacement Form

**Invoice Number:**  
**Company Name:**  
**Phone Number:**  
**Email Address:**

**Date:**  
**PO Number:**

### Cabinet Door Styles

- |  |   |  |  |
|--|---|--|--|
| <input type="checkbox"/> Shaker Arctic <b>SA</b> | <input type="checkbox"/> Shaker Stone <b>SS</b> | <input type="checkbox"/> Shaker Midnight <b>SN</b> | <input type="checkbox"/> Shaker Jade <b>SJ</b> |
| <input type="checkbox"/> Shaker Maple <b>SM</b>  | <input type="checkbox"/> Vidar Pearl <b>VP</b>  | <input type="checkbox"/> Vidar Onxy <b>VX</b>      | <input type="checkbox"/> Vidar Oak <b>VO</b>   |

### Return

Cabinet Style	Item Code	Quantity	Comments

### Replacement

Cabinet Styles	Item Code	Quantity	Comments

13220 Starkey Road, Suite 800,  
 Largo, FL 33773  
 (737) 376-2103  
 sales@diamondedgeinteriors.com



## Limited Warranty for Diamond Edge Interiors LLC

Diamond Edge Interiors LLC ("Diamond Edge Interiors Cabinetry") is pleased to provide the following limited warranty for all cabinets imported, assembled, and sold in the United States by Diamond Edge Interiors Cabinetry. Please note that this warranty does not cover cabinets sold or shipped outside of the United

### Warranty Coverage:

Diamond Edge Interiors Cabinetry warrants to the original purchasing consumer that all cabinets purchased from Diamond Edge Interiors Cabinetry will be free from unnatural defects in material and workmanship, consistent with the Diamond Edge Interiors Cabinetry quality standards sheet, under normal residential use. This warranty extends for a period of 5 years from the date of the original purchase (with 2 years of warranty coverage for paint and stain application) for as long as the original purchasing consumer owns the home in which such cabinets are installed, whichever is less. Please note that this warranty is nontransferable to subsequent owners of the home.

### Warranty Claims:

In the event of a defect occurring within the terms and conditions of this warranty, Diamond Edge Interiors Cabinetry reserves the right to repair or replace the defective part at its sole discretion. However, it's important to clarify that Diamond Edge Interiors Cabinetry will not cover the cost of removal or transportation of the defective product, the repaired or replaced product, or the installation of the repaired or replaced product. Diamond Edge Interiors Cabinetry will also not be held responsible for any shipping damages to the defective, replaced, or repaired product.

If a defective item has been discontinued or is unavailable at the time of the claim, Diamond Edge Interiors Cabinetry retains the right to replace the item with the most similar item available in Diamond Edge Interiors Cabinetry's inventory at that time. It's important to note that due to the natural and appearance of the defective item.

In some cases, Diamond Edge Interiors Cabinetry may require the customer to submit a clear photo or allow a company representative to inspect the claimed item.

### Warranty Limitations:

This limited liability warranty only applies to defects caused by Diamond Edge Interiors Cabinetry.

moisture, extreme temperatures, abrasive or citrus cleaning products, neglect, transit damage, assembly, disassembly, intentional damage, accidents, negligence, on-site alterations, improper storage, defective installation, or normal wear and tear.

This warranty excludes any products used or installed in conjunction with cabinets, such as gas or electric appliances, counter tops, or

It does not apply to products installed in locations without year-round environmental controls.

this limited liability warranty.

The product must be used exclusively for its intended purpose to be covered by this limited liability warranty.

during installation, or if they are used in applications other than normal residential use.

No installer, retailer, distributor, agent, or employee of ArtVidar Cabinetry has the authority to alter the obligations or limitations outlined in this warranty.

For any warranty claims or inquiries, please visit our website at [www.artvidarcabinetry.com](http://www.artvidarcabinetry.com) or contact our customer service team.

## Return Policy

At Diamond Edge Interiors LLC, our commitment is to provide our customers with top-quality products and outstanding service. To guarantee a seamless and hassle-free experience, we kindly request that you carefully review our return policy.

Upon the receipt of your order, it is imperative to verify the contents for completeness and accuracy before accepting the delivery or

### Time Limit for Claims:

Please take note that any claims pertaining to incorrect or missing items will NOT be honored if reported beyond **7 days** from the date of delivery or pickup. We highly encourage our customers to promptly inspect their orders to identify any discrepancies.

### Procedure for Damaged or Missing Items:

In the unfortunate event that you encounter damaged or missing items in your delivery or pickup, please adhere to the following

If any items in the delivery or pickup exhibit signs of damage or are documentation is pivotal for processing your claim.

**Immediate Contact with Diamond Edge Interiors Cabinetry:** Following the documentation of the issue on the delivery or pickup [sales@diamondedgeinteriors.com](mailto:sales@diamondedgeinteriors.com) or by calling 737-376-2103.

**Providing Comprehensive Information:** When communicating with us, we request that you provide detailed information regarding the damaged or missing items. This should include your order number, a comprehensive description of the issue, and, if feasible, relevant photographs. The information you provide will expedite the resolution process.

### Resolution of Claims:

Upon receipt of your report and the requisite information, our team will initiate a thorough investigation into the matter. We will work diligently to resolve the issue to your utmost satisfaction. This may involve arranging replacements for damaged or missing items or

*Note: Please retain all original packaging materials until the issue is satisfactorily resolved, as they may be required for return or replacement purposes.*

### Returns for Refund:

We acknowledge that situations may arise necessitating a product return. All eligible returns are only subject to a credit on the account to

**Time Frame:** Cabinet returns for a refund are permissible within **30 days** from the delivery/pickup date.

**Condition:** To qualify for a refund, cabinets must be in impeccable condition and in their original packaging. Cabinets **NOT ELIGIBLE** for return.

**Proper Documentation:** To initiate a return for a refund, you must provide the necessary paperwork, which includes SALES ORDER OR INVOICE NUMBER and a return authorization issued by Diamond Edge Interiors LLC.

responsibility for return shipping costs rests with the customer.

At Diamond Edge Interiors LLC, we greatly value your trust and are dedicated to ensuring your complete satisfaction with our products and services, whether they are delivered or picked up. We sincerely appreciate your cooperation in adhering to this return policy, as it assists us in serving you better.

Should you have any inquiries or require further assistance regarding our return policy, please do not hesitate to contact our customer service team. We are here to provide support

